



For more information visit www.paradigm.com/shift



Set-Up Guide

Paradigm®

The Official Sound of **you™**

sondtrack
System
Amplified Soundbar and Wireless Subwoofer

What's in the box . . .

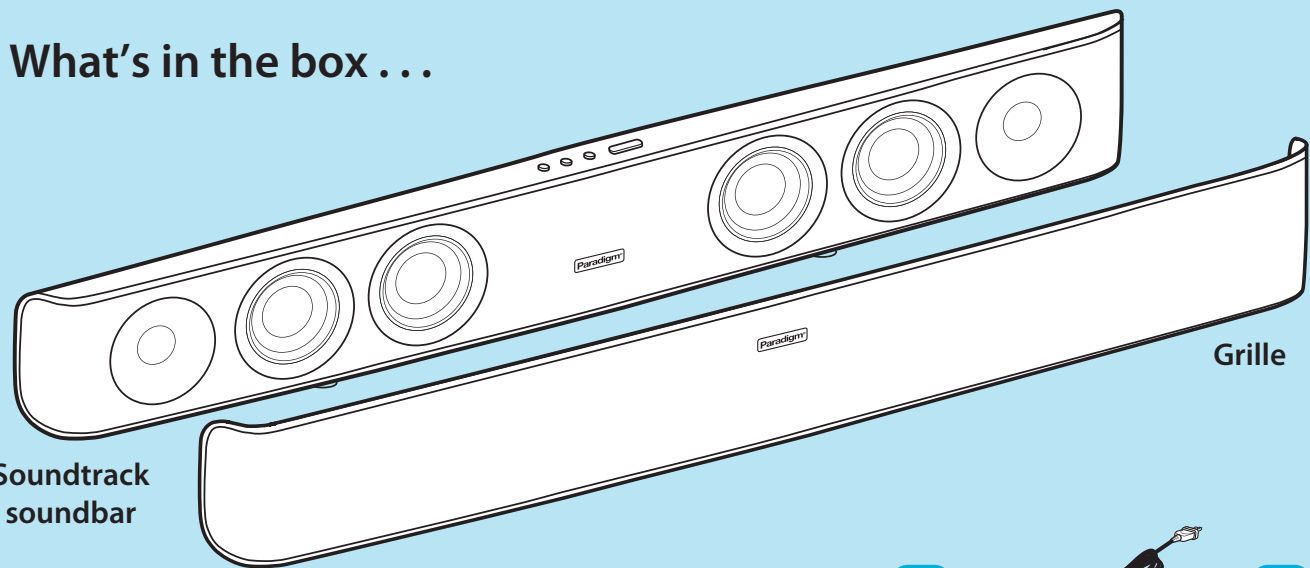

Soundtrack
soundbar

Grille



Remote

Your Soundtrack System is capable of learning codes from remote controls you are using for other sources. See manual for details.

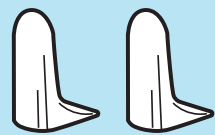

Feet

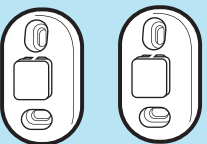

On-wall brackets

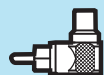

(Adaptor for use in horizontal position, wired connection only)

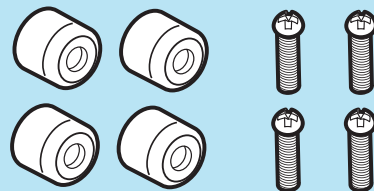

Subwoofer feet and screws

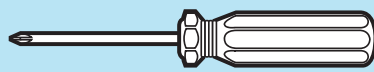

#2 Phillips (not supplied)

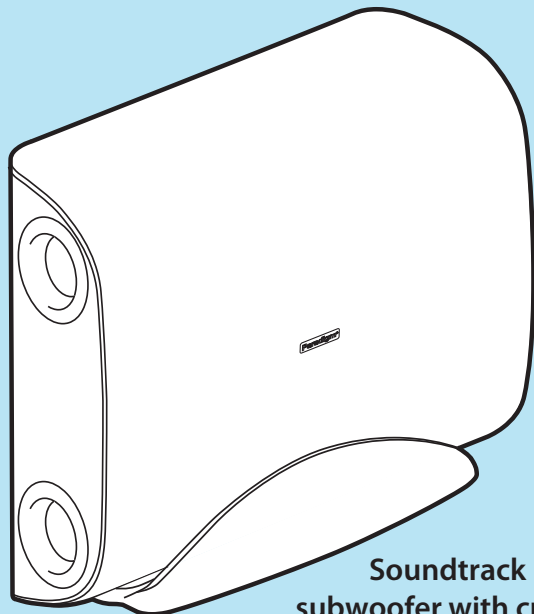

Soundtrack
subwoofer with cradle

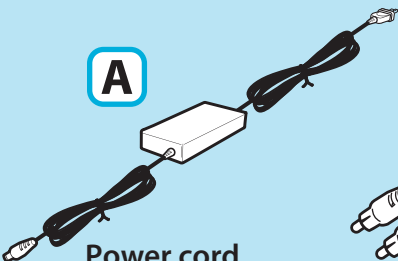

Power cord

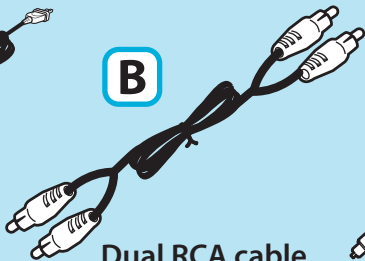

Dual RCA cable



Digital optical cable

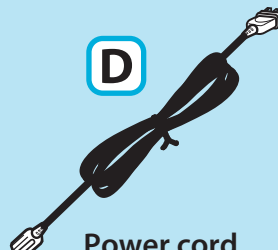

Power cord

BEFORE YOU BEGIN, READ THE SAFETY PRECAUTIONS AND IMPORTANT SAFETY INSTRUCTIONS INCLUDED IN THE OWNERS MANUAL.

Setting up the soundbar

1 Attach the Feet

Lay your soundbar face down on a soft surface. Insert feet as shown, press firmly until you hear a 'click'.

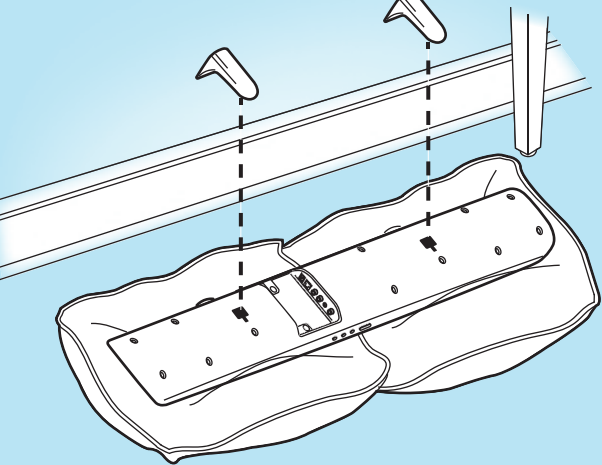

2 Connecting to source

NOTE: Choose analog OR digital connections

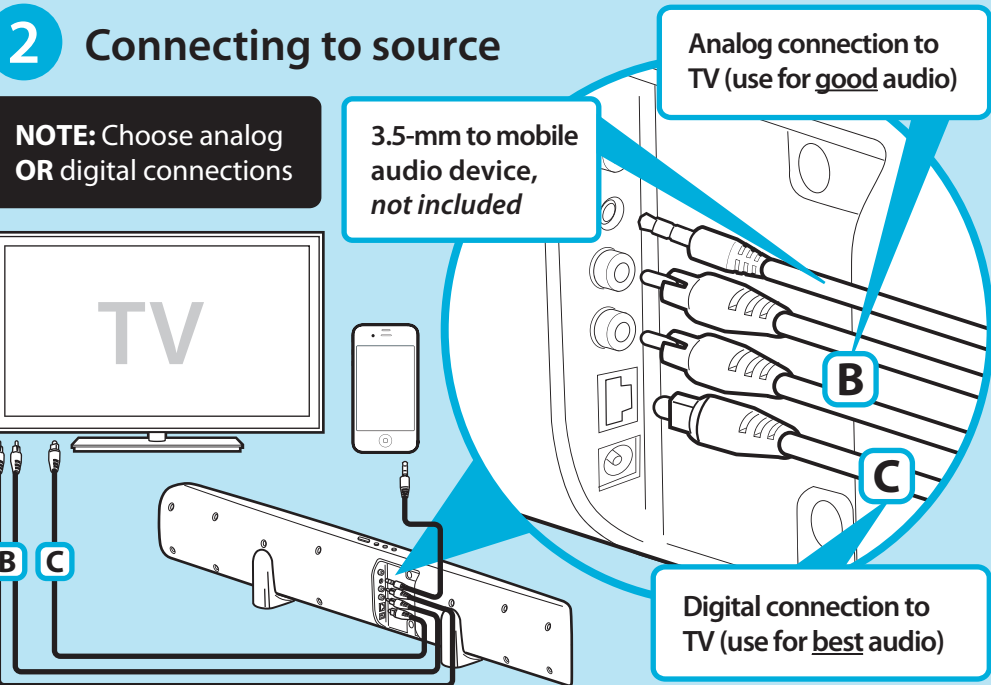

3 Power connection

Connect to power source.

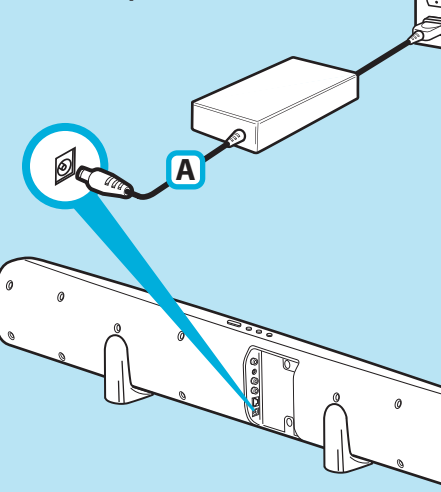

OPTIONAL

Attach feet to subwoofer for horizontal positioning

Attach the feet.

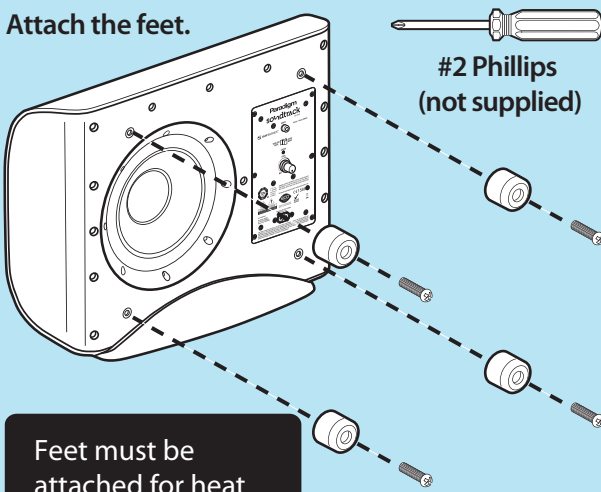

Feet must be attached for heat dissipation clearance

Wireless pairing

1 Power on, sync to subwoofer

Using the Remote or Onboard Interface. Turn Power ON and repeatedly press Input Selector until you hear audio. Press the Wireless Sync button to initiate connection to subwoofer.

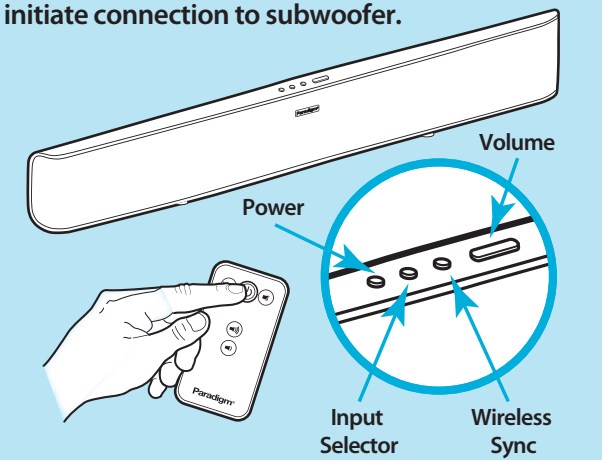

2 Wireless status indicator

The Wireless Status Indicator on the soundbar should blink blue for less than 30 seconds and then go back to normal operation.

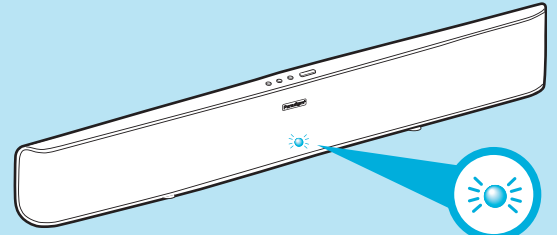

*If the soundbar Wireless Status Indicator alternates between red and blue blinking, pairing has failed and the process must be repeated.

3 Power connection

Connect to power source.

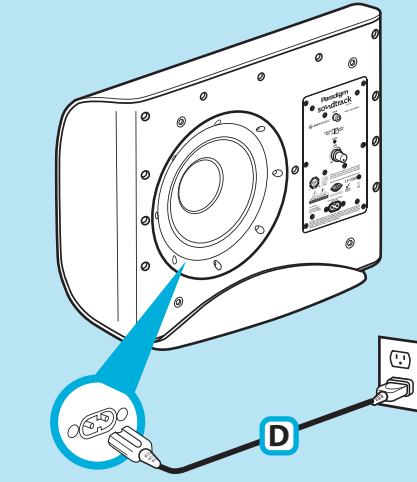

4 Wireless setting

Move switch to "wireless" setting on subwoofer.

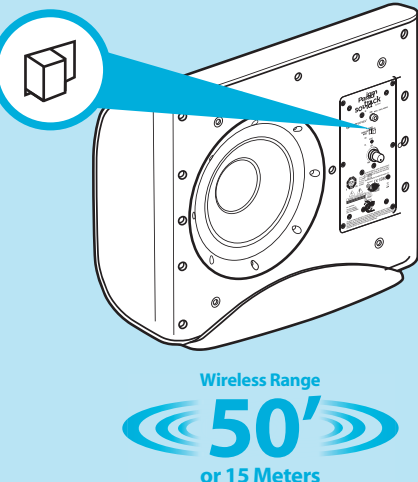

5 Adjust subwoofer loudness

Your subwoofer's LEVEL switch is set to 12 o'clock to suit average preferences. If desired, adjust up or down to match sound level of your speakers.

